

RESIDENTIAL CONSTRUCTION PROBLEM SOLVER

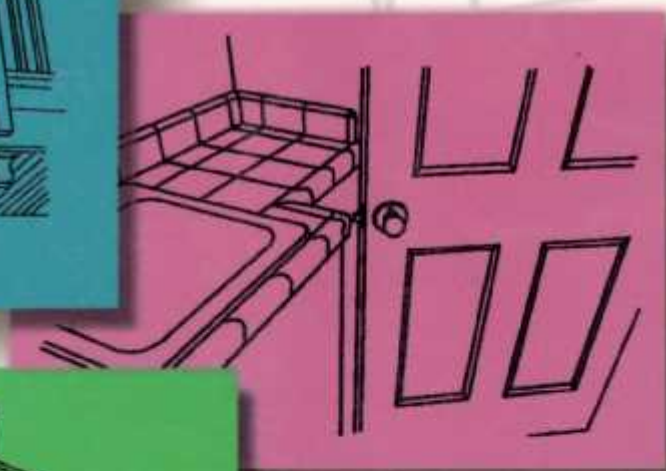

- Prevents Problems Before They Occur
- 1200 Illustrations
- Checklist Format



BART JAHN

McGraw-Hill

A Division of The McGraw-Hill Companies



Library of Congress Cataloging-in-Publication Data

Jahn, Bart

Residential construction problem solver/Bart Jahn.

p. cm.

ISBN 0-07-032962-1 (hardcover).—ISBN 0-07-032961-3 (pbk.)

1. House construction—Handbooks, manuals, etc. 2. Building failures—Prevention—Handbooks, manuals, etc. 3. Accidents—Prevention—Handbooks, manuals, etc. I. Title.

TH4813.H37 1998

690'.837—dc21

98-15167

CIP

Copyright © 1998 by The McGraw-Hill Companies, Inc. All rights reserved. Printed in the United States of America. Except as permitted under the United States Copyright Act of 1976, no part of this publication may be reproduced or distributed in any form or by any means, or stored in a data base or retrieval system, without the prior written permission of the publisher.

1 2 3 4 5 6 7 8 9 0 KGP/KGP 9 0 3 2 1 0 9 8

ISBN 0-07-032962-1 (H)

0-07-032961-3 (P)

The sponsoring editor for this book was Zoe G. Foundatos, the editing supervisor was Penny Linskey, and the production supervisor was Clare Stanley. Interior design by Jaelyn J. Boone. Composition by Jaelyn J. Boone and Michele Pridmore of McGraw-Hill's Professional Book Group in Hightstown, New Jersey.

Printed and bound by Quebecor/Kingsport.

McGraw-Hill books are available at special quantity discounts to use as premiums and sales promotions, or for use in corporate training programs. For more information, please write to the Director of Special Sales, McGraw-Hill, 11 West 19th Street, New York, NY 10011. Or contact your local bookstore.

This book is printed on recycled, acid-free paper containing a minimum of 50% recycled, de-inked paper

Information contained in this work has been obtained by The McGraw-Hill Companies, Inc. ("McGraw-Hill") from sources believed to be reliable. However, neither McGraw-Hill nor its authors guarantee the accuracy, or completeness of any information published herein, and neither McGraw-Hill nor its authors shall be responsible for any errors, omissions, or damages arising out of use of this information. This work is published with the understanding that McGraw-Hill and its authors are supplying information, but are not attempting to render engineering or other professional services. If such services are required, the assistance of an appropriate professional should be sought.

CONTENTS

Introduction ix

- | | | | | | |
|----|---------------------------------------------------|-----|----|-------------------------------------------------------------------|-----|
| 1 | Rough Grading, Underground Utilities, and Streets | 1 | 20 | Cabinets | 208 |
| 2 | Concrete Foundations and Slabs | 24 | 21 | Finish Carpentry | 227 |
| 3 | Masonry Block Retaining Walls | 37 | 22 | Ceramic Tile | 249 |
| 4 | Layout and Wall Framing | 45 | 23 | Insulation, Lath, and Stucco | 271 |
| 5 | Framing Floors and Ceilings | 59 | 24 | Roofing | 279 |
| 6 | Layout and Framing for Doors | 73 | 25 | Painting | 282 |
| 7 | Layout and Framing for Windows | 83 | 26 | Hardware | 291 |
| 8 | Framing Stairs | 96 | 27 | Finish Plumbing, Electrical, and HVAC | 304 |
| 9 | Shear Panel | 104 | 28 | Miscellaneous Finish | 313 |
| 10 | Fireplace Framing | 108 | 29 | Flooring | 331 |
| 11 | Roof Framing | 113 | 30 | Concrete Walkways and Driveways | 345 |
| 12 | Moment Frames | 121 | 31 | Walls, Fences, and Gates | 379 |
| 13 | Exterior Framing | 125 | 32 | Miscellaneous Exterior | 409 |
| 14 | Miscellaneous Framing | 130 | 33 | Landscaping | 414 |
| 15 | Framing for Bathtubs | 134 | 34 | Construction Management | 433 |
| 16 | Backing | 137 | 35 | The Superintendent, the Construction Trailer, and Field Paperwork | 437 |
| 17 | Straightedge | 144 | 36 | The Final Preparation Phase | 445 |
| 18 | Rough Plumbing, Electrical, and HVAC | 150 | 37 | Customer Service | 448 |
| 19 | Drywall | 190 | 38 | Sales Models | 454 |
| | | | | <i>Index</i> | 459 |